

D

C

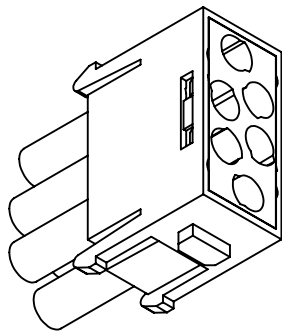
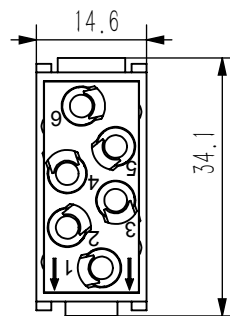
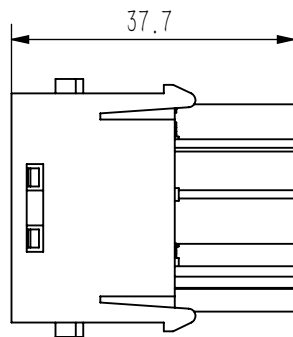

技术参数:

插芯:

- 插针安数: 6
- 额定电流: 16A
- 额定电压: 830V
- 额定脉冲电压: 8KV
- 污染等级: 3
- 依据UL/CSA的额定电压: 600V
- 绝缘阻抗:  $\geq 10^9 \Omega$
- 材料: 聚碳酸酯
- 颜色: RAL 7032 (浅灰色)
- 温度范围:  $-40^\circ\text{C} - +125^\circ\text{C}$
- 依据UL 94的阻燃等级: V0
- 可插拔次数:  $\geq 500$

插针:

- 接线方式: 冷压连接
- 材料: 铜合金
- 表面处理:
  - 镀银
  - 镀金
- 接触电阻:  $\leq 1\text{m}\Omega$
- 线径范围:  $0.14-4\text{mm}^2$  (26-12 AWG)
- 工具:
  - 冷压钳
  - 退针器

Technical specification :

Insters :

- No.of contact : 6
- Rated current : 16A
- Rated voltage : 830V
- Rated impulse voltage : 8KV
- Pollution degree : 3
- Rated voltage acc.to UL/CSA : 600V
- Insulation resistance :  $\geq 10^9 \Omega$
- Material: polycarbonate
- Colour : RAL 7032 ( light grey )
- Temperature range :  $-40^\circ\text{C} - +125^\circ\text{C}$
- Flammability acc.to UL 94 : V0
- Mating cycles :  $\geq 500$

Contacts :

- Terminal : screw terminal
- Msterial : copper alloy
- Surface :
  - hard-silver plated
  - hard-gold plated
- Contact resistance :  $\leq 1\text{m}\Omega$
- Wire gauge :  $0.14-4\text{mm}^2$  ( 26-12 AWG )
- Tools:
  - Crimp contact tool
  - Contact removal tool

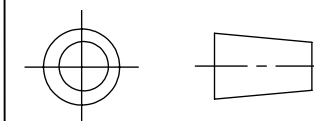

订货号 Order No.

版本  
REV

重量  
weight

比例  
Scale

产品代号 Part Code

V1.0

9.8g

1:1

SO-HVME-006-FC



SMICO

浙江思美克电气科技有限公司  
ZHEJIANG SMICO ELECTRICAL TECHNOLOGY CO.,LTD